

# TECHNICAL INFORMATION

## Slimlift 6230



**Installation:** Wall or floor

**Adjustability:** Motor-driven, continuously adjustable 30.0 cm (64.0 - 94.0 cm excl. worktop)

**Speed:** 1.8 cm / sec.

**Operation:** Fixed button or remote control

**Safety:** Security strip can be positioned below the worktop. Contact with the strip stops the lift

**Electrical connection:** Mains plug for 230 V, max 2,5A

**Connection of water and drainage:** Connection is by means of flexible hoses

**Max. load:** 150 kg (55.0-175.0 cm), 250 kg (195.0-255.0 cm)

**Enclosure-class:** IP 20

**Front height:** Selected according to requirement

**Dimensions cover plates:** Width = Top board's width, Height 43.8 cm, Thickness 1.2-1.6 cm

**Depth worktop:** 56.5 - 80.0 cm

**Width:** 55.0 - 255.0 cm

**Space to wall / adjoining cupboard:** 0.5 cm

**Space to wall (for files):** 1.5 cm

**Tiling:** 64.0 cm above floor

**Material:** Frame and motors in aluminium. Powder coated sheet-metal parts (Alu-grey RAL 9006)



### DIMENSIONS

(cm)

#### Dimensions worktop - Model 6230

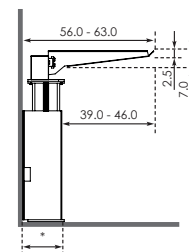
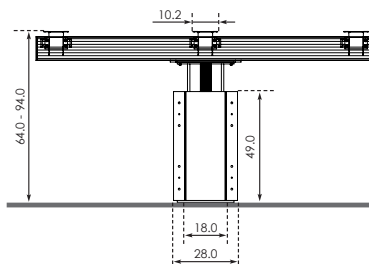
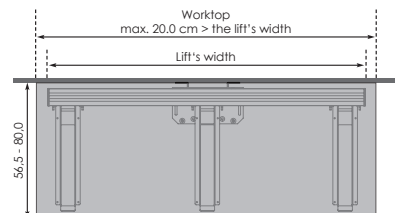

Depth, motor 17.5 cm  
Depth, floor plate 18.5 cm

#### Dimensions worktop - Model 6233

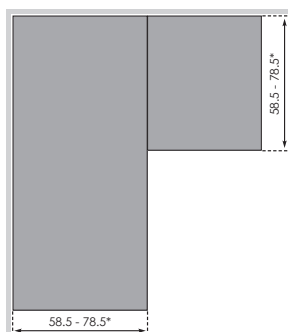

\* Relates to 60.0 - 80.0 cm depth of adjoining worktop  
(This gives a 1.5 cm space for files and movement)



[www.inclusiveliving.com.au](http://www.inclusiveliving.com.au)  
1300 304 330