

## MANULIFT 6380H – Worktop Lifts



The Manulift 6380H is a **manual WALL mounted height adjustable worktop lift system**, it is used to **lower and raise worktops vertically**. The manual solution is applicable for **occasional adjustment**. For frequent adjustments, electric applications are more suitable.

The wall mounted **worktop is adjusted manually** up to 30 cm by 2.5cm intervals. The height is adjusted by loosening the wall bracket's screws and then moving the worktop to the height required.

It can be used in **seated** or **standing** positions. The open area below/underneath the worktop surface provides extra space for legs and knees, thus allowing for easy and direct access.

The 6380H series has **increased** frame height for installation the of **sinks, cooktops, draws and chopping boards**. Equipment in the worktop surface is selected according to the desired function.

Other options – manual systems can be converted to electric systems in required in the future.



**MODELS - MANULIFT 6380H – WALL MOUNTED WORKTOP SYSTEMS - STRAIGHT**



Manulift 6380H  
for widths 59cm to 100cm



Manulift 6380H  
for widths 109cm to 180cm



Manulift 6380H  
for widths 189cm to 240cm

**Key Features:**

- Adjustability - 30cm by 2.5cm intervals (70cm - 100cm) excl. worktop
- Sizes – custom worktop lifts **ranging** from 59cm up to 240cm in width
- Frames supplied assembled – for quicker installation
- Maximum Load – 100kg
- Manufacturer – Granberg of Sweden
- Warranty – 2 years manufacturers

**Accessories:**

- Cover panels – telescopic cover panels can be installed underneath worktop to cover motors and services to provide a more discreet appearance
- Cover panels dimensions – worktops width x height 43.8cm x thickness 1.2cm – 2.0cm
- Fittings for cover panels
- Front facias – aluminium (white or silver)
- Drawers can be fitted into worktops
- Rear edge trim – Aluminium
- Hose cover for services
- Protective panel used underneath worktop



Cover panels



Cover panel fittings



Fronts



Rear Edge Trim



Drawer



Hose Cover



Protective Panel

**MODELS - MANULIFT 6380H – WALL MOUNTED WORKTOP SYSTEMS - STRAIGHT**

**Installation:**

- Wall mounted and as per manufacturers manual
- Adjustment – 30cm by 2.5cm intervals
- Frame depth – 56.5 cm – 58.0cm from wall
- Worktop depth – 56.5cm – 63.0cm
- Front heights – 10.3cm
- Space - Lateral to wall/adjourning worktop or cabinet – 0.5cm
- Space – back wall to worktop 1.5cm (approx. for tiles)
- Delivered in modules – assembled worktop surface, wall mounted motors, fittings for fronts

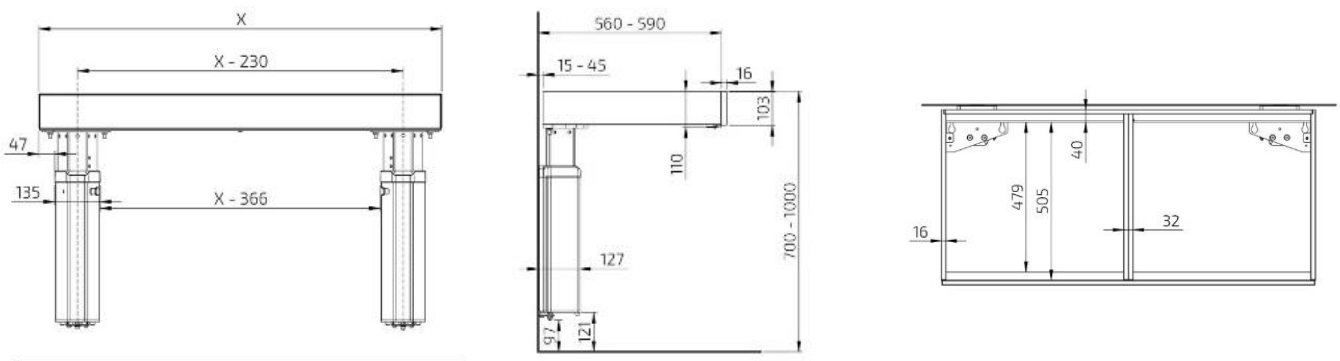

## Manulift 6280 for WALL CABINETS – WALL MOUNTED

Manulift 6380 is a hook mounting system for wall cabinets which provides **manual** adjustment in increments of 5cms up to a total of 25cms. This manual solution is applicable for **occasional adjustment**. For frequent adjustments, electric applications are more suitable.

The cabinets are suspended on the aluminium rail at the required height. Adjustable spacers are inserted at the lower edge of the cabinet. (To compensate for the cabinet's extension at the upper edge). Suitable for cabinet height 70.0cm – 110.0 cm



### Installation:

- An aluminium rail is screwed onto the wall. Hooks are screwed behind the cabinet. The cabinet installed onto the hooks.

### Key Features:

- Adjustability – 25.0cm by 5.0cm intervals
- Suitable for cabinet height 70.0cm – 110.00cm
- Maximum Load – 80kg
- Extension from wall – 1.8cm
- Space to wall/adjoining cupboards – 0.5cm
- Material – Aluminium
- Manufacturer – Granberg of Sweden
- Warranty – 2 years manufacturers